

Interchangeable Forming Shoe set

PARTS (7 pieces)

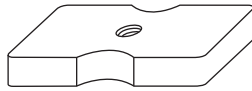

size 1



size 3



size 2

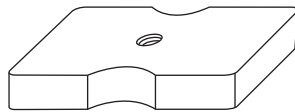

size 4

forming pieces x4

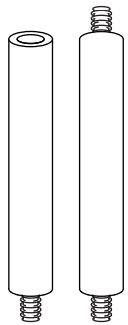

neck pieces x2



base x1

Assembly Instructions:

Determine which forming size piece you need to use for your bags. The different sizes also require different neck lengths. Please see the list below for reference.

2oz & 4oz	use size 1 (1-9/16" x 1-3/16")
6-10oz & 12-16oz	use size 2 (3" x 2-1/8")
2lb	use size 3 (4-1/2" x 2-15/16")
5lb	use size 4 (6-1/2" x 4-1/8")

1. Screw neck pieces onto the base.
2. Affix the forming piece to the top of the neck. You will notice that each forming piece has a completely flat side and a side that has slightly rounded edges. The rounded edges need to be on top and the flat side needs to be on the bottom to ensure the bags don't get damaged when using the forming shoe.
3. Screw parts until scured. Avoid forcing or screwing parts too tightly.
4. Your forming shoe is now ready to use.

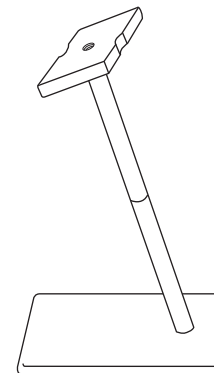

* This unit and all of its parts meet the FDA requirements for contact with food products and it is completely washable.